

# Crisis

Crisis is a national charity for single homeless people. They want to raise their profile by posting cardboard collecting boxes into every home in the UK.

You are asked to design a card collecting box which will help to raise their profile. The box must be capable of folding flat for easy storage.

Marks will be awarded for:

- A creative solution which clearly promotes the charity
- Details of materials and construction
- Surface graphics and use of colour
- Details of how the box will fold flat

Below, draw a 3D view of your collection box, adding notes and/or sketches to explain how it folds flat.

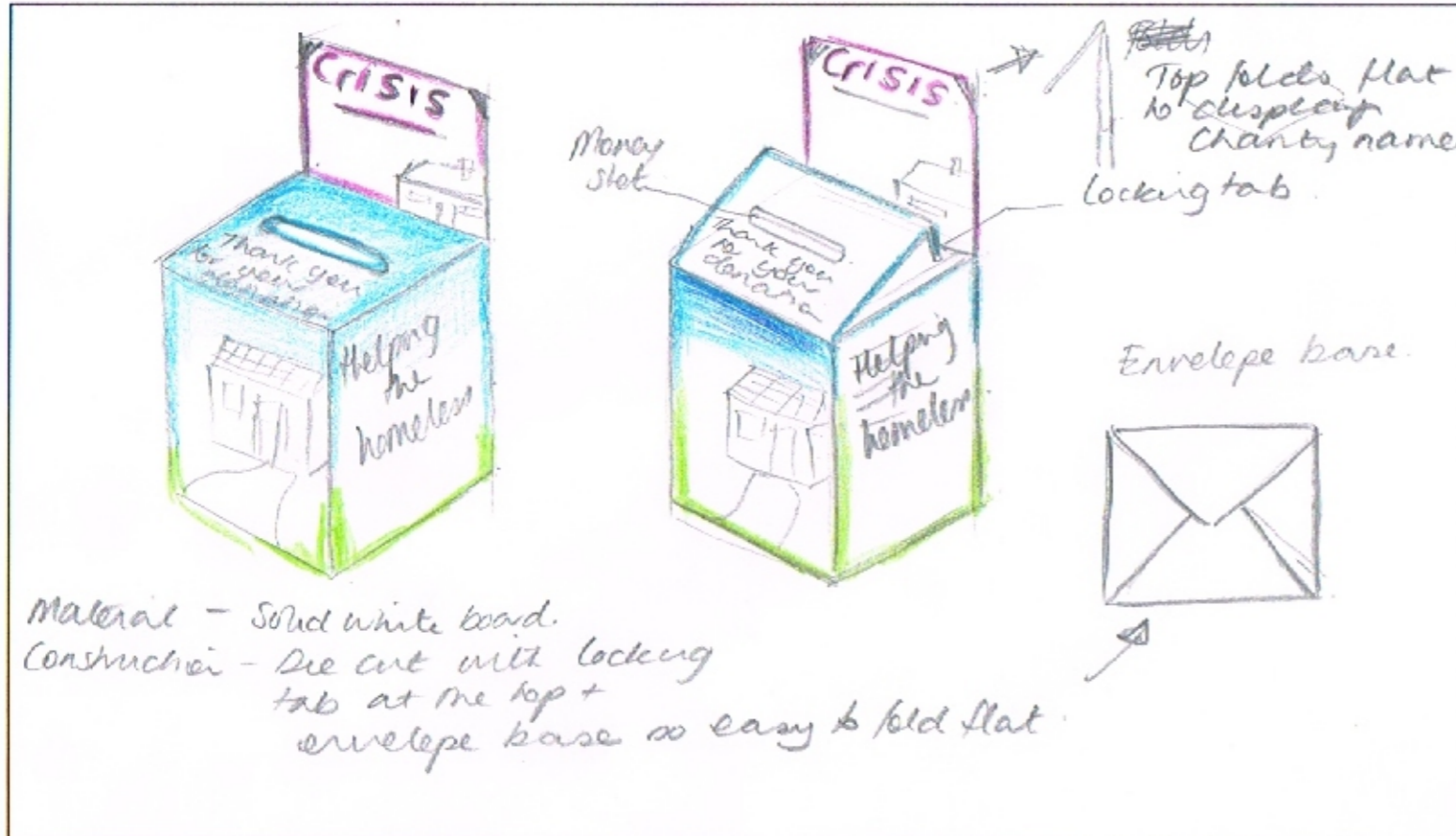

Complete the table showing important criteria for your collection box and give your reasons. An example has been provided.

Design criteria	Reasons
The box must fold flat	This will reduce storage space and make it easier to transport the boxes from the printers to the charity
The box must display the charity logo.	So that the donator knows who they are making a donation to
The box must be strong	So that it can hold sufficient amount of money without collapsing

In the space below draw the net for your collection box.

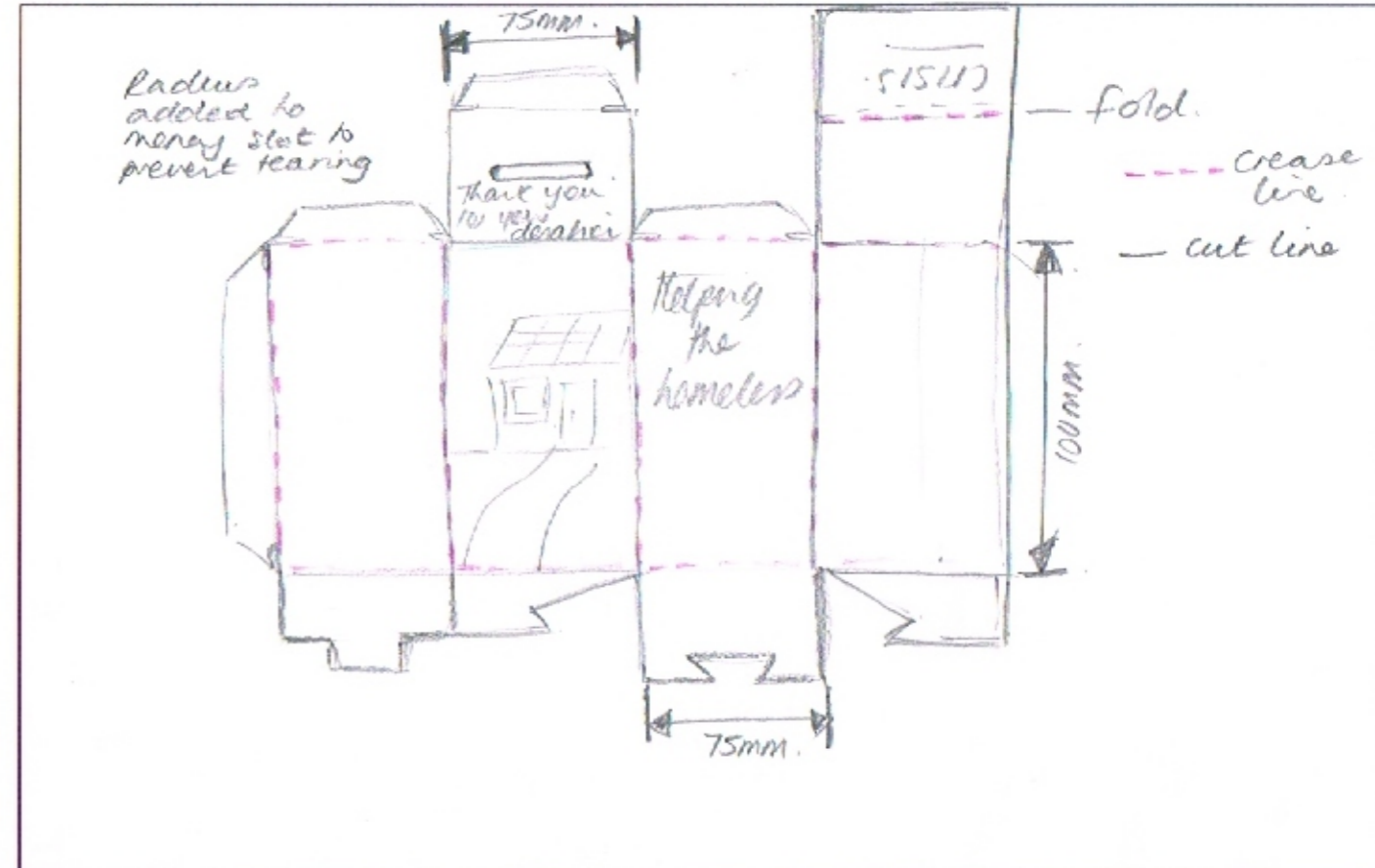

Using the design criteria above to assist you, evaluate your design proposal as to its effectiveness as a collection box as well as a promotional product

- The box must display the logo - The box clearly displays the charity name at the front of the collection box.
- The box must be strong - The box will be constructed with a combination of locking tabs, gluing tabs and an envelope base that is self locking.
- The box must fold flat - The net shows how the net product folds flat.